

# Fiskars® ShapeCutter™ Plus

- The ShapeCutter™ Plus allows you to create a variety of shapes easily, with a wide range of ShapeCutter™ templates or by using the freehand method.
- The ShapeCutter™ Plus can be used with a wide variety of materials, such as paper, photos, card, fine leather, fabric, etc, **up to a thickness of 210g**.
- The depth of the blade can be easily adjusted to the thickness of the material being used.
- Comes with one replacement blade.

## 1. Features

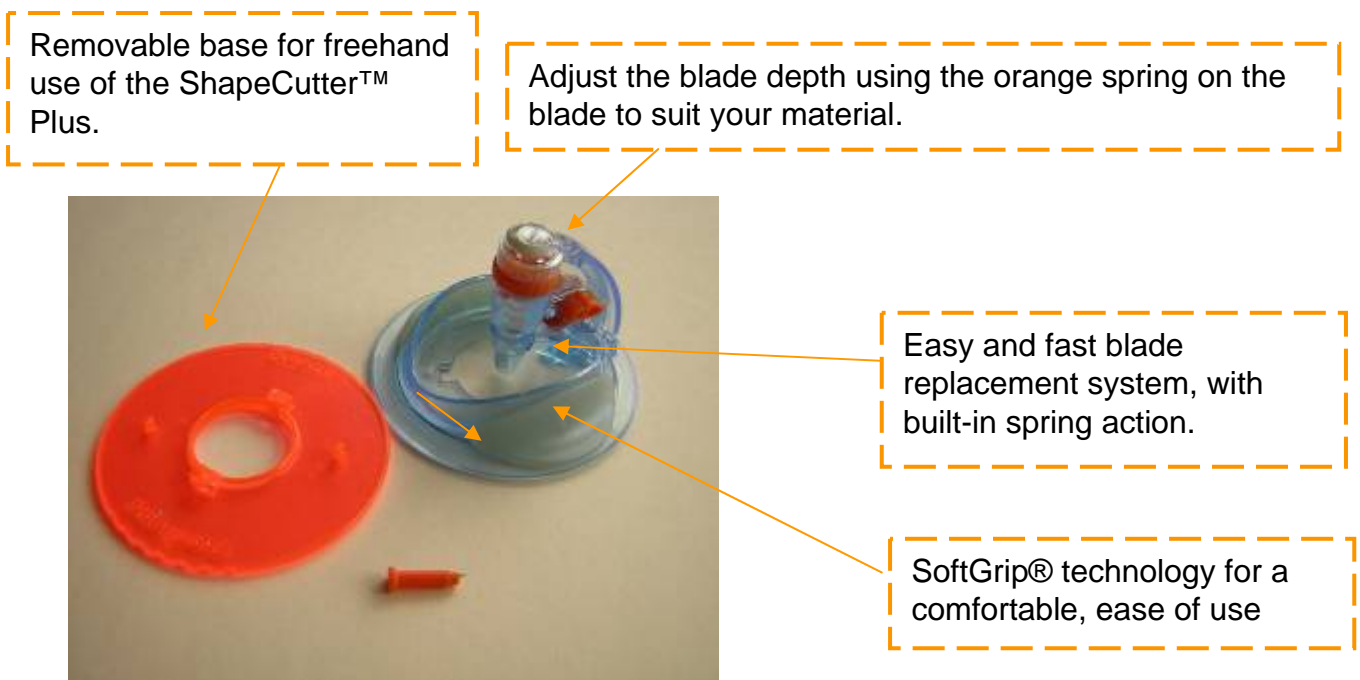

*Its base has been specially designed to protect the blade from damage when the ShapeCutter™ is not in use.*

## 2. Cutting blade



The blade of the ShapeCutter™ Plus must be correctly adjusted for a perfect cut.

### 1/ Inserting – Replacing the blade

Unblock the arm of the ShapeCutter™ Plus by moving the orange button (from the picture of the open padlock) to open the compartment.

Drop the blade into the compartment.

Return the arm to its initial position and secure it in place by moving the orange button (to the picture of the closed padlock).



### 2/ Adjusting the blade

Adjust the depth of the blade by tightening the adjustable spring with the help of the grid markings (to lower the blade) or unscrew the orange spring (to retract the blade).

As a guide, lower the blade for thick paper, so that the blade can perforate it completely and, conversely, retract the blade when using thinner paper.



### 3. Self-healing cutting mat

The ShapeCutter™ Plus must be used with a cutting mat.

Fiskars® transparent cutting mat (ref. 8610 or 8608) helps protect your work surface and prolongs the life of your blades.



The main feature of this mat is its flexibility, which guarantees a smooth cut with the ShapeCutter™ Plus.

Use the self-healing reverse side, i.e., the side with the Fiskars® logo in the top left hand corner, for the ShapeCutter™ Plus and the other activities including gluing & painting.

### 4. Templates

Fiskars®'s vast range of templates have been specially designed to be used with the ShapeCutter™ Plus.

To make that sure you use the correct side of these templates with the ShapeCutter™ Plus, check that the Fiskars® logo is in the top left hand corner. If you are using the correct side, you should be able to “feel” the logo.



Look out for Fiskars®'s new ranges of interesting templates every year!

## Freehand use



The ShapeCutter™ Plus can be used in its freehand mode by keeping the orange part attached to the tool.



## Using templates



Place your material between the mat and the template.  
Remove the orange part of the ShapeCutter™.  
Position the tool against the edge of the shape template.

For best results, you should be able to feel a cushion of a few millimeters between the template and the ShapeCutter™ Plus, simply by pressing



## 5. Handling the ShapeCutter™ Plus

The easiest way to hold the ShapeCutter™ Plus is by making your hand into a letter “C” around the tool.

This is the easiest way to hold the ShapeCutter™ Plus and it also allows you to follow the movement of the blade through the transparent section.

**Correct handling**



**Incorrect handling**

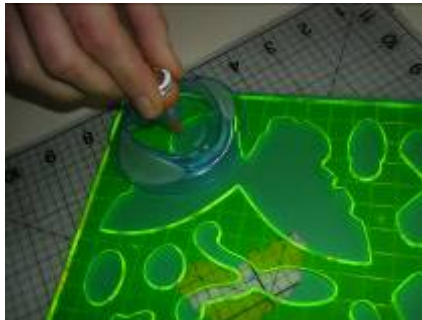

**Tip:**

*Always start cutting from a straight edge, rather than a corner or bend. Also, make sure the blade is facing in the same direction as the way you are cutting.*

*Do not swirl your hand over the shape.*

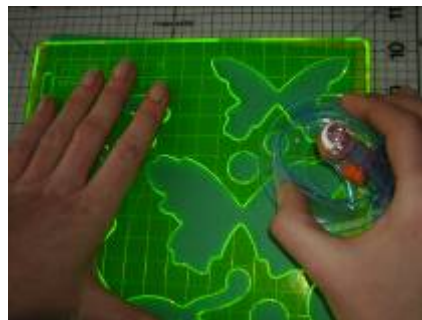

## 5. Tips

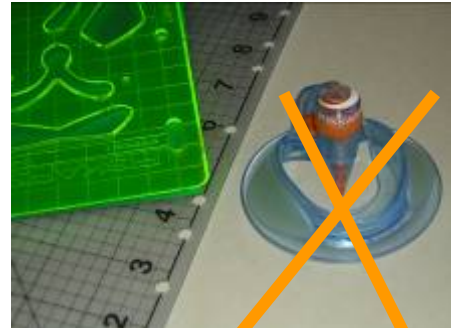
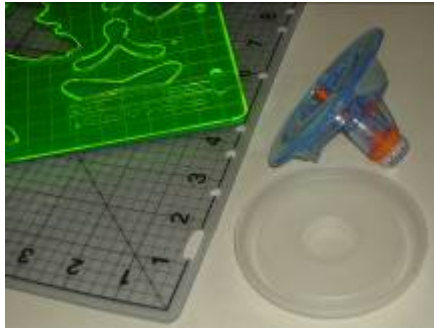

After using the ShapeCutter™ Plus, you can help preserve its blade by replacing it on its transparent base or laying it on its side.

Never leave the ShapeCutter™ Plus facing down on your work surface as this will damage the blade (and your surface!).

When cutting natural or fibrous paper-making material, use the ShapeCutter™ Plus on the reverse side of the paper, as this is smoother. Also, if you encounter some resistance whilst cutting, lift the ShapeCutter™ Plus up and move it just after the notch so as not to damage the blade. You can then cut that area with a pair of precision scissors.

It is advisable to use one blade for each type of medium or, indeed, one pair of scissors for fabrics and one for paper. By so doing, you will prolong the life of the blade and the scissors.

### **Tip:**

*When cutting fabric, it is advisable to place it against some scrap paper (80g). Use heat sealing paper or glue with temporary gluing properties to stick your fabric to the paper then use the ShapeCutter™ Plus on the paper side.*

*This technique makes the fabric a little firmer, which facilitates a more precise cut.*

*When you have finished cutting the fabric, simply remove the paper.*

\*\*\*