

FISKARS®

Instructions for Replacing the rail in Fiskars SureCut personal paper trimmers



01-005249



01-005445



01-005454



01-005446



CAUTION: Remove blade from rail before starting

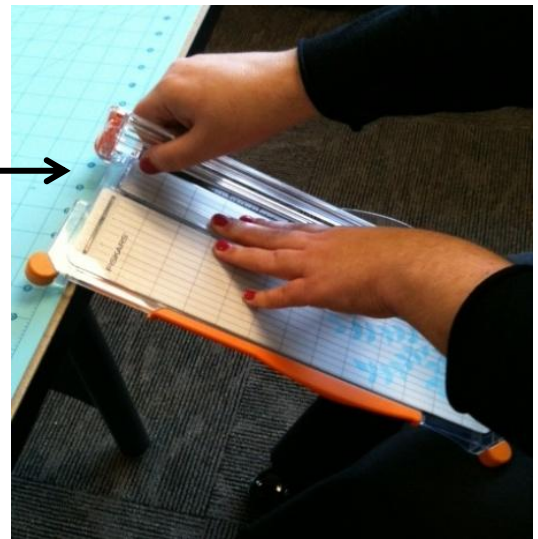
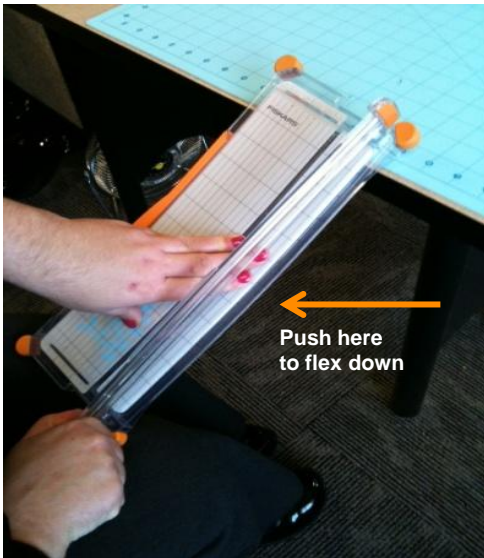

To remove existing rail:

The base of the trimmer has a little bit of flexibility. Place one end of the trimmer up against the edge of table and stabilize the other end in your lap. Push downward on the middle of the trimmer until the base flexes and you can pull the top end of the rail out.

To insert new rail:

Insert bottom peg of rail into the bottom end. Again, push on the middle of the trimmer so that that the base flexes. Insert the top end of the rail into the top end of the trimmer.

FISKARS®